

WGI Miniature Needle Valves

Carbon Steel / Stainless Steel

Specifications

Sizes

1/8" & 1/4" NPT

Maximum Operating Pressure

6000 psi

Body & Bonnet Material

A105 Carbon steel or 316 Stainless Steel

Stem Material

316 Stainless steel

Stem Packing

PTFE Teflon®

Stem

Rotating

Seat Material (WN06 & WN04 Series)

PTFE Teflon®

Temperature Rating

-40° to 500°F (-40 to 250°C)



WN0532

Dimensions & Part Numbers

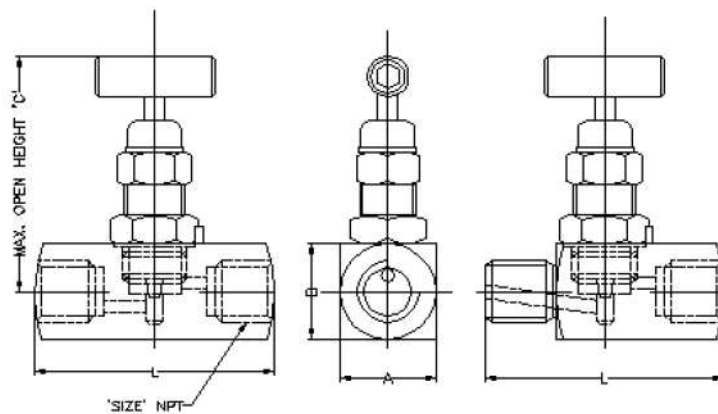

Part No.	Size	Pattern	Ends	Material	A	B	C	L	D	Cv
WN0311	1/8"	G	FxF	316SS	20.0	20.0	52.0	32.0	32.0	0.25
WN0312	1/4"	G	FxF	316SS	20.0	20.0	52.0	32.0	32.0	0.25
WN0332	1/4"	G	MxF	316SS	20.0	20.0	52.0	32.0	32.0	0.25
WN0432*	1/4"	G	MXF	316SS	20.0	20.0	52.0	32.0	32.0	0.25
WN0511	1/8"	G	FxF	C/S	20.0	20.0	52.0	32.0	32.0	0.25
WN0512	1/4"	G	FxF	C/S	20.0	20.0	52.0	32.0	32.0	0.25
WN0532	1/4"	G	MxF	C/S	20.0	20.0	52.0	32.0	32.0	0.25
WN0632*	1/4"	G	MXF	C/S	20.0	20.0	52.0	32.0	32.0	0.25

* SOFT SEAT